

## 2012-13 Aerial Photos

# Aerial 1 : Manor Farm and Queen Mary Quarry (QMQ)



SURREY



Page 93



# 2012-13 Aerial Photos

## Aerial 2 : Manor Farm and Queen Mary Quarry (QMQ)



Page 94

QMQ Ashford Road Access

A308 QMQ Access

Worple Road access

QMQ Processing Plant Site

Manor Farm

Application Site Area

Conveyor tunnel under Ashford Road

Ashford Road temporary access

Conveyor cause way



# Plan 2 : Extraction phases, site compound, conveyor tunnel and causeway (annotated applicant SP2012/01132 drawing no. EIA9.8 Rev B March 2012)

Page 95

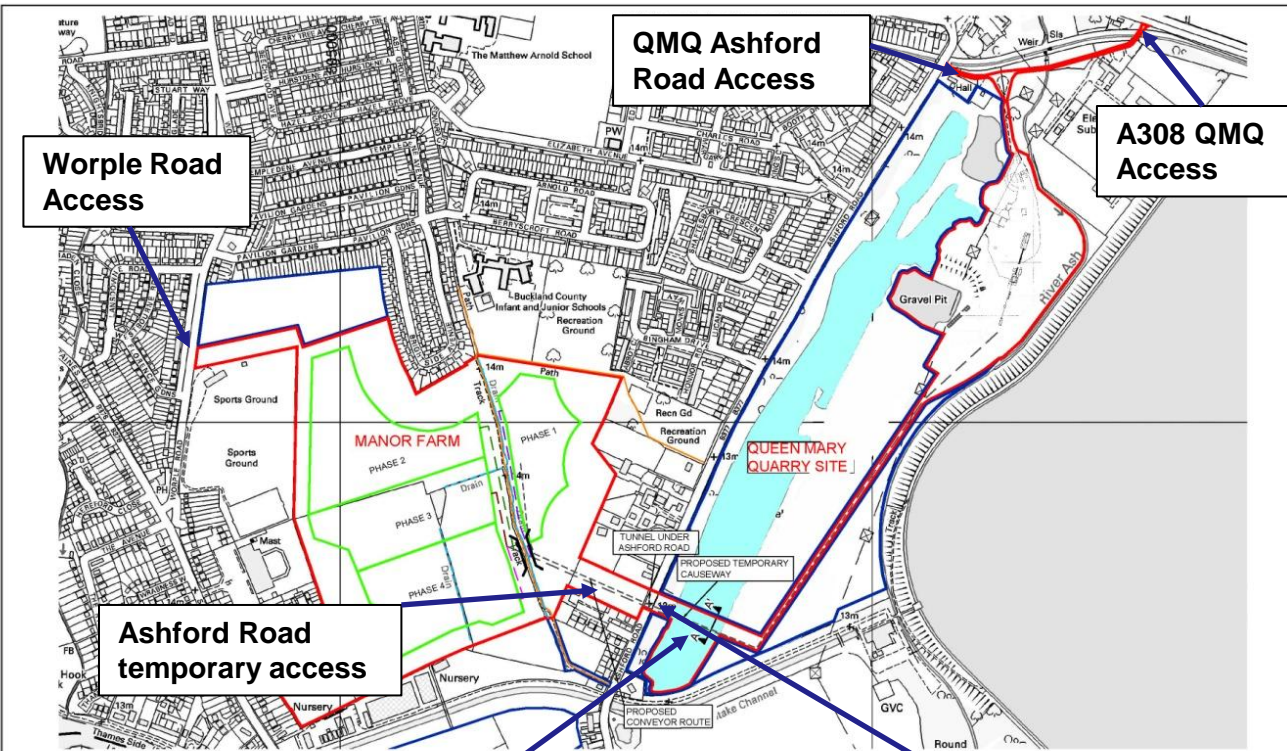

DO NOT SCALE FROM THIS DRAWING

KEY

- APPLICATION SITE
- OTHER LAND UNDER APPLICANT'S CONTROL
- PUBLIC FOOTPATH
- DRAIN
- PROPOSED CONVEYOR ROUTE
- PHASE 1 CONVEYOR ROUTE
- PHASE 2 CONVEYOR ROUTE
- PHASE 3 CONVEYOR ROUTE
- PHASE 4 CONVEYOR ROUTE
- CONVEYOR TUNNEL BENEATH FP30
- PHASE BOUNDARY

REVISION	DETAILS	DATE	DRAWN	CHECKED	APPROVED
B	Conveyor Routes Added	23/06/12	JR	RK	SK
A	Issued as Approved	16/03/12	CS	CS	SK

CLIENT: Brett Aggregates Limited

PROJECT: Proposed Mineral Extraction from Manor Farm, Laleham

DRAWING TITLE: Conveyor Route Details

DRG No: EIA9.8	SCALE: NTS	DATE: MARCH 2012
DRAWN BY: JD	CHECKED BY: CS	APPROVED BY: RK
<input checked="" type="checkbox"/> STONE-ON-TRENT (HEAD OFFICE)	TEL 0945 111 7777	<input type="checkbox"/> CARDIFF TEL 029 2073 8191
<input type="checkbox"/> NEWCASTLE UPON TYNE	TEL 0191 232 0943	<input type="checkbox"/> SHEFFIELD TEL 01942 280101
<input type="checkbox"/> WEST BROMBACH	TEL 0121 580 0809	<input type="checkbox"/> EDINBURGH TEL 0131 555 5311
<input type="checkbox"/> LONDON	TEL 020 7287 2872	<input type="checkbox"/> LIVERPOOL TEL 0151 484 8431

Conveyor cause way

Conveyor tunnel under Ashford Road

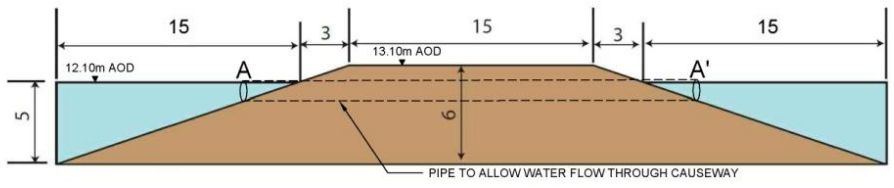

CAUSEWAY CROSS SECTION





# Plan 3 : Conveyor Switch Point Locations (annotated applicant drawing) (ST12377-025)

Page 96

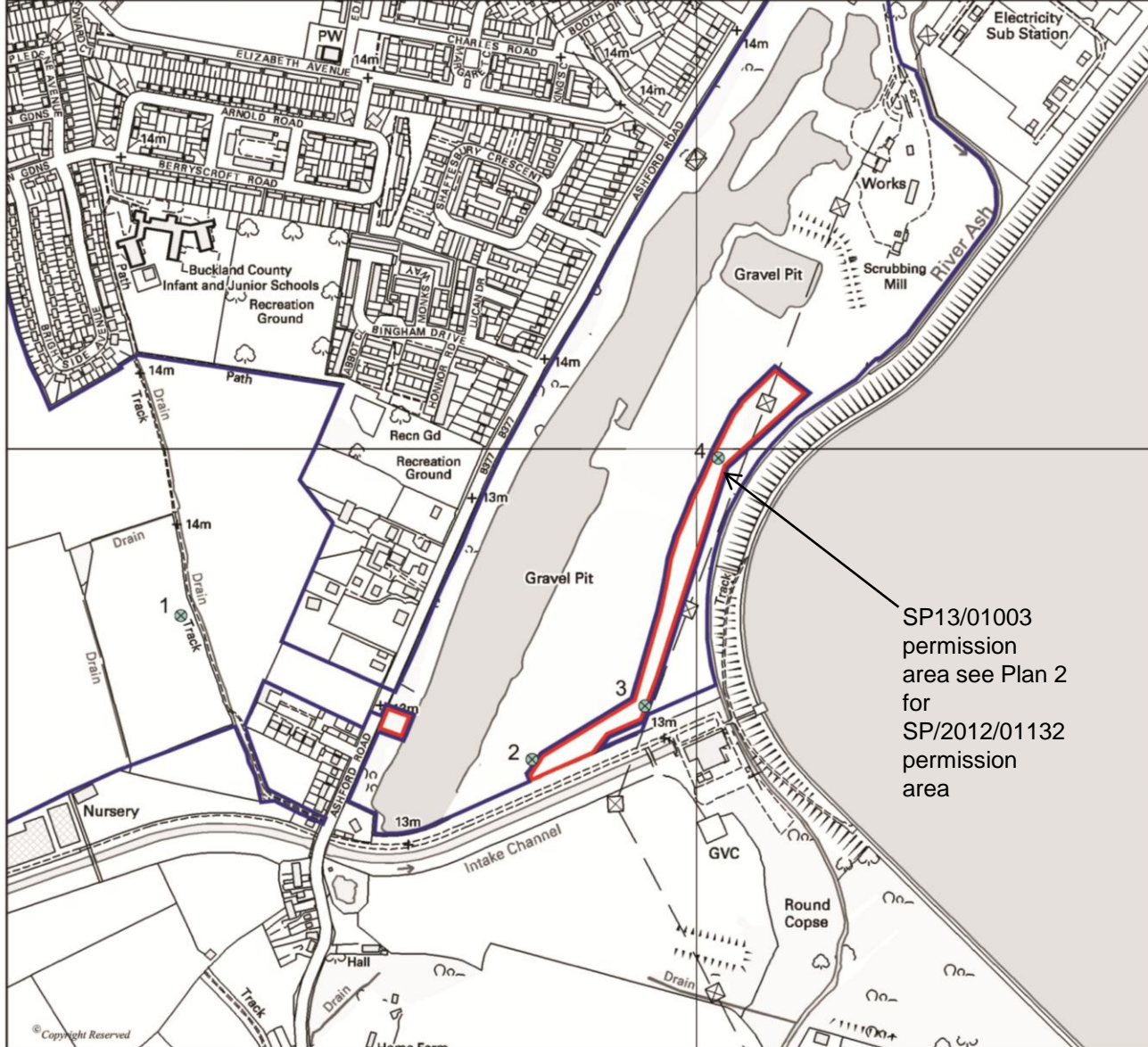

SP13/01003 permission area see Plan 2 for SP/2012/01132 permission area

DO NOT SCALE FROM THIS DRAWING A3

**REFERENCE**

- APPLICATION SITE (SP13/01003)
- OTHER LAND UNDER THE APPLICANT'S CONTROL
- SWITCH POINTS LOCATIONS

REVISION	DETAILS	DATE	DRAWN	CHECKED	APPROVED
A	First Issue	11/03/16	PG	GAH	RK

CLIENT: Brett Aggregates Limited

PROJECT: Proposed Mineral Extraction from Manor Farm, Laleham

DRAWING TITLE: Switch Point Locations

DRG No:	SCALE:	DATE:
ST12377-025	1:5000	10/03/16

DRAWN BY:	CHECKED BY:	APPROVED BY:
PG	GAH	RK

STIKES-ON-TRENT TEL 0945 111 7777  CARDIFF TEL 029 2072 9191  
 HEAD OFFICE  LISH TEL 01932 260191  
 NEWCASTLE-UPON-TYNE TEL 0191 232 0943  SHEFFIELD TEL 0114 245 0244  
 WEST BROMWICH TEL 0121 580 0909  EDINBURGH TEL 0131 655 3311  
 LONDON TEL 020 7287 2872  TALUNTON TEL 01823 703106

wardell armstrong your earth our world